

Tyler/Union

DUCTILE IRON C110 FLANGED FITTINGS

Sizes 3" thru 12" UL Listed for Fire Main Equipment

SAMPLE SPECIFICATION

Flanged Fittings, 2" through 48" shall be manufactured of Ductile Iron in accordance with all applicable terms and provisions of standards ANSI/AWWA C110/A21.10 (current revisions). Flange surface shall be faced and drilled in accordance with ANSI Class 125 B16.1. All Ductile Iron Flanged Fittings shall be rated for water pressure of 250 PSI. NOTE: Fittings are CEMENT-LINED and seal coated in all accordance with ANSI/AWWA C104/A21.4, also available prime coated, bare or epoxy coated. All coated fittings shall be in accordance with NSF-61. Interiors shall be lined and seal coated in accordance with ANSI/AWWA C104/A21.04 "Cement-mortor Lining for Ductile Iron Pipe and Fittings for Water" unless otherwise specified.

FLANGE DETAILS

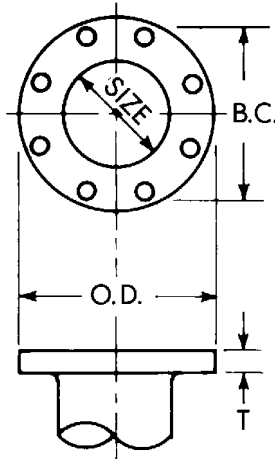

NOTE: No flange joint material furnished.

Nominal Pipe Size Inch	Flange O.D.	Dia. of Bolt Circle	Flange Thickness T	Bolt Hole Diameter	Number of Bolts	Bolt Dia. and Lengths
2	6	4.75	.62	.75	4	5/8 x 2 1/4
3	7.5	6	.75	.75	4	5/8 x 2 1/2
4	9	7.5	.94	.75	8	3/8 x 3
6	11	9.5	1.00	.875	8	3/4 x 3 1/2
8	13.5	11.75	1.12	.875	8	3/4 x 3 1/2
10	16	14.25	1.19	1.00	12	7/8 x 4
12	19	17	1.25	1.00	12	7/8 x 4
14	21	18.75	1.38	1.125	12	1 x 4 1/2
16	23.5	21.25	1.44	1.125	16	1 x 4 1/2
18	25	22.75	1.56	1.25	16	1 1/8 x 5
20	27.5	25	1.69	1.25	20	1 1/8 x 5
24	32	29.5	1.88	1.375	20	1 1/4 x 5 1/2
30	38.75	36	2.12	1.375	28	1 1/4 x 6 1/2
36	46	42.75	2.38	1.675	32	1 1/2 x 7
42	53	49.50	2.62	1.625	36	1 1/2 x 7 1/2
48	59.50	56.00	2.75	1.625	44	1 1/2 x 8

NOTE: Drilling templates are in multiples of four, so that fittings may be made to face in any quarter. Bolt holes shall straddle the center line.

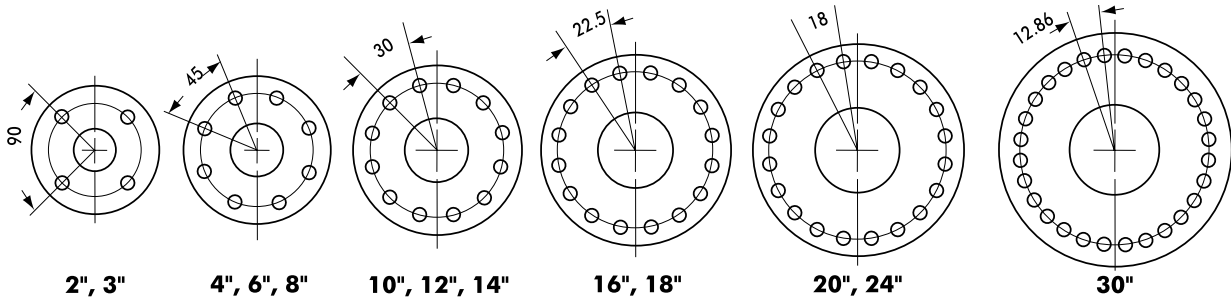

BENDS

Note: Base Bends are on page 33 and 34, reducing and long radius 90° bends are on page 33.

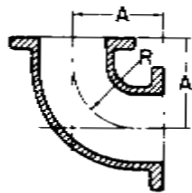

90° Bends (1/4)

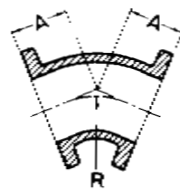

45° Bends (1/8)

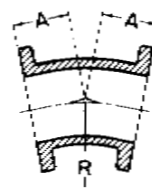

22 1/2° Bends (1/16)

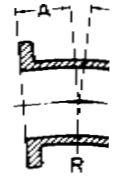

11 1/4° Bends (1/32)

Size	Dimensions			Weight	Dimensions			Weight	Dimensions			Weight
	R	A	Weight		R	A	Weight		R	A	Weight	
2	3.0	4.5	14	
3	4	5.5	26	3.62	3	20	7.56	3	22	15.25	3	20
4	4.5	6.5	44	4.81	4	36	10.06	4	35	20.31	4	40
6	6	8	67	7.25	5	57	15.06	5	64	30.5	5	56
8	7	9	115	8.44	5.5	105	17.62	5.5	90	35.5	5.5	90
10	9	11	164	10.88	6.5	131	22.62	6.5	130	45.69	6.5	130
12	10	12	236	13.25	7.5	196	27.67	7.5	194	55.81	7.5	193
14	11.5	14	330	12.06	7.5	245	25.12	7.5	250	50.75	7.5	245
16	12.5	15	478	13.25	8	315	27.62	8	315	55.81	8	315
18	14	16.5	527	14.5	8.5	422	30.19	8.5	402	60.94	8.5	385
20	15.5	18	878	16.88	9.5	485	35.19	9.5	505	71.06	9.5	505
24	18.5	22	1085	18.12	11	730	37.69	11	528	76.12	11	760
30	21.5	25	1755	27.75	15	1355	57.81	15	1385	116.75	15	1395