

# Tyler/Union

1/8 x 1/32 in. Letters

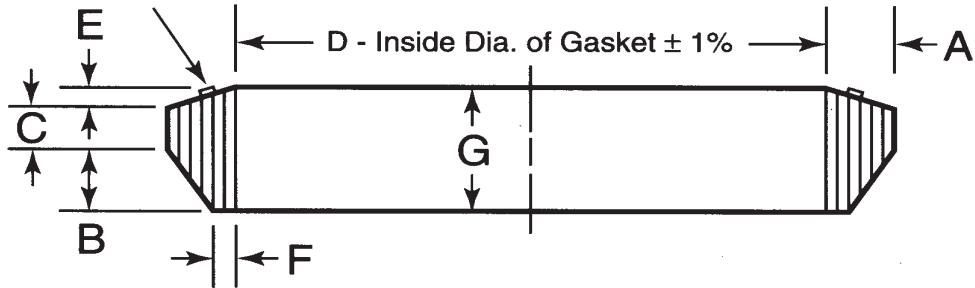

**Mechanical Joint Transition Gasket Dimensions in Inches**

Pipe Size	A $\pm 0.01"$	B	C	D $\pm 1\%$	E	F $\pm 0.01"$	G $\pm 0.02"$
3	.70	.62	.31	3.45	.16	.37	1.11
4	.77	.75	.31	4.43	.16	.37	1.26
6	.76	.75	.31	6.53	.16	.36	1.25
8	.82	.75	.31	8.50	.16	.42	1.27
10	.79	.75	.31	10.59	.16	.39	1.26
12	.84	.75	.31	12.56	.16	.44	1.28

## Excavation dimensions - MJ 4" through 12" Tapping Sleeves for Ductile Pipe

