

SAMPLE SPECIFICATION

Flanged Fittings, 2" through 48" shall be manufactured of Ductile Iron in accordance with all applicable terms and provisions of standards ANSI/AWWA C110/A21.10 (current revisions). Flange surface shall be faced and drilled in accordance with ANSI Class 125 B16.1. All Ductile Iron Flanged Fittings shall be rated for water pressure of 250 PSI. NOTE: Fittings are CEMENT-LINED and seal coated in accordance with ANSI/AWWA C104/A21.4, also available prime coated, bare or epoxy coated. All coated fittings shall be in accordance with NSF-61. Interiors shall be lined and seal coated in accordance with ANSI/AWWA C104/A21.04, "Cement-mortar Lining for Ductile Iron Pipe and Fittings for Water" unless otherwise specified.

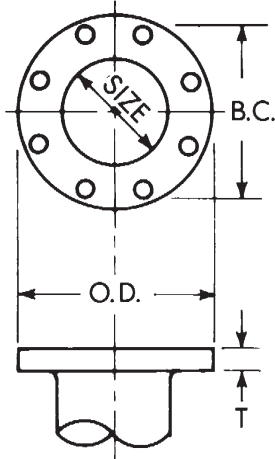

NOTE: No flange joint material furnished.

FLANGE DETAILS

Nominal Pipe Size Inch	Flange O.D.	Dia. of Bolt Circle	Flange Thickness T	Bolt Hole Diameter	Number of Bolts	Bolt Dia. and Lengths
2	6	4.75	.62	.75	4	5/8 x 2 1/4
3	7.5	6	.75	.75	4	5/8 x 2 1/2
4	9	7.5	.94	.75	8	5/8 x 3
6	11	9.5	1.00	.875	8	3/4 x 3 1/2
8	13.5	11.75	1.12	.875	8	3/4 x 3 1/2
10	16	14.25	1.19	1.00	12	7/8 x 4
12	19	17	1.25	1.00	12	7/8 x 4
14	21	18.75	1.38	1.125	12	1 x 4 1/2
16	23.5	21.25	1.44	1.125	16	1 x 4 1/2
18	25	22.75	1.56	1.25	16	1 1/8 x 5
20	27.5	25	1.69	1.25	20	1 1/8 x 5
24	32	29.5	1.88	1.375	20	1 1/4 x 5 1/2
30	38.75	36	2.12	1.375	28	1 1/4 x 6 1/2
36	46	42.75	2.38	1.675	32	1 1/2 x 7
42	53	49.50	2.62	1.625	36	1 1/2 x 7 1/2
48	59.50	56.00	2.75	1.625	44	1 1/2 x 8

NOTE: Drilling templates are in multiples of four, so that fittings may be made to face in any quarter. Bolt holes shall straddle the center line.